



FalcOnWood  
gevelbekleding





## FalcOnWood facade cladding!

The many years of experience we have built up allows us to now rightfully call ourselves true specialists in facade cladding. We work with architects and supply our facade cladding to wood and building materials' wholesalers. We also like to share our expertise and put this to good use for construction projects by offering project management services.



# 01 Table of contents

## 02. Our qualities

Exceptional quality by using the very best materials

## 03. Product range

Very complete range in terms of colors, finishes, models and sizes

## 04. FalcOnWood finishes

From fine to coarsely sawn and brushed, but also fire-retardant and thermally modified

## 05. FalcOnWood colors

All colors of the rainbow and more form part of the possibilities

## 06. Assembly instructions

How to assemble our facade cladding

## 07. Maintenance instructions

Maintenance has never been so easy

## 08. Warranty

You can find out what we stand for in our warranty conditions

## 09. Realized projects

Pictures say more than a thousand words



# 02 Our Qualities

## Exceptional quality

The quality of FalcOnWood's wooden facade cladding is truly unrivaled. The exceptional quality is because we work with the very best materials and the wood is sorted and inspected up to five times. We subsequently enhance the wood's natural beauty by using an ultra-modern sawing technique. The final finishing touch is added by applying 3 layers of exclusive and sustainable paint to the planks, which ensures an absolutely optimal result.

## Expertise

The many years of experience we have built up allows us to now rightfully call ourselves true specialists in facade cladding. We mainly work with architects and supply our facade cladding to wood and building materials' wholesalers. We also like to share our expertise and put this to good use for construction projects by offering project management services.

## Warranty of up to 25 years

The final product speaks for itself and our company is more than happy to offer you the best possible warranty.



## Collaborations

The benefits of working together with us are:

### Fast delivery times

We hold a large stock of untreated wood; all finishing activities are done in the Netherlands. This allows us to offer fast delivery times.

### Customization & flexibility

We can offer customization in terms of colors, finishes, models and sizes, because we produce the products ourselves.

### Competitively priced

We like to demonstrate the fact that good quality and customer-focused services effectively go hand in hand with an accessible price.

### Short lines

Our specialists will quickly answer any of your questions and would be more than happy to think along with you both before and during the installation process. We can also supply product technical drawings and offer technical support & project management services.

### Why do we use Lodgepole Pine?

Lodgepole Pine is a Canadian pine which grows very slowly and evenly. Lodgepole Pine can reach a height of 50 meters and a diameter of 90 cm. Lodgepole Pine's straight growth has resulted in this type of wood being ultimately suitable for facade cladding.

A number of advantages associated with using Lodgepole Pine for facade cladding compared to other types of wood are:

- It's a homogeneous product;
- The wood's slow growth means it's very stable;
- Long lengths can be also be supplied.



## Sustainable

FalcOnWood products are made from sustainable wood and are PEFC certified.



## Low maintenance

Our facade cladding requires minimal maintenance and will therefore last for years.



## Quality

Full control over the basic product through our own quality controls and CE marking/declaration of performance.



## 03 Product range



FalcOnWood Swedish Rebate



FalcOnWood Channel Siding



FalcOnWood  
Half-Timbered Rebate



FalcOnWood Rhombus



FalcOnWood Boards  
and Battens



FalcOnWood Double Rhombus



FalcOnWood Inside and  
Outside Corner



FalcOnWood Start Profile



## 04 FalcOnWood finishes



### Finely sawn

Finely sawing the Lodgepole Pine will slightly roughen the visible side of the facade cladding. This will then give the facade cladding a robust appearance.



### Roughly sawn

Coarsely sawing the Lodgepole Pine will make the visible side of the facade cladding extra rough. This will then give the facade cladding a tougher and more robust appearance.



### Brushed

Brushing the Lodgepole Pine will remove the soft wood between the wood grains. This will serve to beautifully emphasize the wood grains. Resulting in a fantastic, natural look.



### Fire-retardant

Wooden facade cladding forms part of fire class D as standard. We increase the fire class to fire class B by impregnating the facade cladding. This can be done in 2 different ways: impregnation based on fire-retardant salts, or based on polymers.



### Thermally modified

Extend the facade cladding's life from sustainability class 4 (a lifespan of approximately 10 years) to sustainability class 1 (a lifespan of 15 to 25 years) with a thermal heat treatment. The facade cladding is heated to 200 degrees using steam in a low-oxygen room, which changes the facade cladding's cell structure. This is an environmentally friendly treatment.

## 05 FalcOnWood colors



### Opaque colors

A sealer/wood impregnating agent is applied as the first layer with our opaque colors for optimal adhesion. The facade cladding is subsequently finished off with an opaque 2-layer top coating.



### Semi-transparent

A sealer/wood impregnation agent is applied as the first layer with our semi-transparent colors for optimal adhesion. A colored top coating is subsequently applied. A transparent lacquer is then finally applied to create a nice nuance in the color scheme.



### Pre-greying

Pre-greying means the facade cladding is treated with a grey tint. This will ensure the aging process takes place evenly.





# 06 Assembly instructions

## Ventilation

There needs to be a continuous minimum ventilation space depth of 20 mm behind the FalcOnWood facade cladding. Double battening must be used to guarantee ventilation when the vertical facade cladding is applied.

- Ventilation slats are not permitted;
- The ventilation can't be disrupted or restricted;
- The ventilation openings and vents must have a minimum depth of 20mm.

## Ventilation openings

The ventilation openings, both at the top and bottom, can't be blocked by, for example, paving, vegetation, a raised patio or raised garden. This would result in insufficient ventilation, which would subsequently cause a disproportionate moisture load, condensation or moisture accumulation in the cavity. The moisture would then come out through the visible side of the panels. This, in turn, would have harmful consequences for the wooden facade cladding's lifespan.

## Vapor-tight/vapor-permeable foil

A vapor-tight foil must be applied to the inside of the inner cavity wall. In addition, a vapor-permeable foil must also be applied to the outside of the insulation material.

## Expansion space

The ends are cut at 22 degrees to create the best possible result. The wooden parts must be mounted with 3 mm expansion space in width, in order to give them sufficient space in case of any possible shrinking and/or expansion. The sawn ends will still need to be treated 2 times with 2 layers of FalcOnWood paint.

## Distance to ground level

There must always be a minimum distance of 200 mm between ground level and the underside of the FalcOnWood facade cladding. The wooden panels may not come into contact with the masonry.

## Battening

The facade cladding is generally secured to dry wooden battening. The battening size must minimally be 28 x 45 mm.

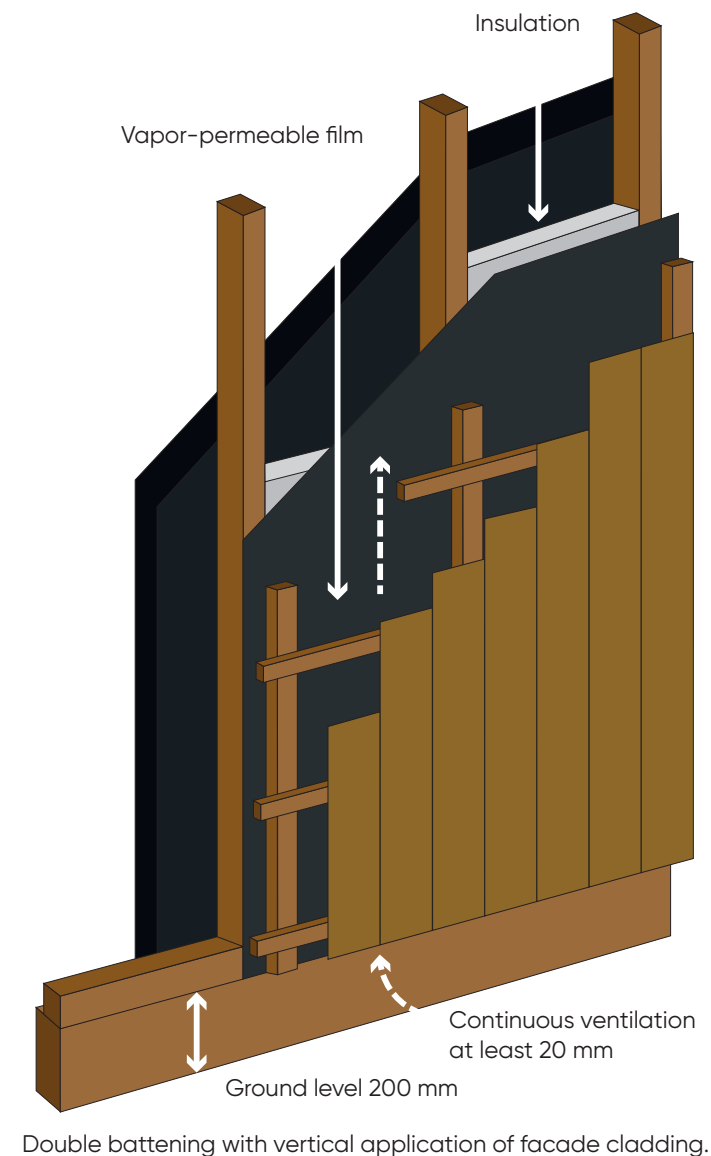

You can read the abbreviated version of our installation instructions in this brochure. Our complete installation instructions can be found on: [www.falconwoodgevel.nl/montagevoorschriften](http://www.falconwoodgevel.nl/montagevoorschriften)



## Securing the facade cladding

A maximum securing of 400 mm c.t.c. applies to the planks, with grooved stainless steel nails of 2.7 x 50 mm / 2.7 x 65 mm, or with stainless steel screws of 3.5 x 55 mm. The nails will need to minimally penetrate 25 mm into the wooden surface. The nails will need to be fixed at 25 mm from the ends and 30 mm from the bottom at the ends. The seams will need to meet on a wider back batten in order to guarantee decent securing with the nails.

## Securing to the facade cladding

You may not secure any burdensome constructions, like a sun canopy, rain gutters, etc. to the facade cladding. This will void the warranty.





## 07 Maintenance instructions

Please find an abbreviated version of our maintenance instructions below. You can find our complete maintenance instructions on: [www.falconwoodgevel.nl/onderhoudsvoorschriften](http://www.falconwoodgevel.nl/onderhoudsvoorschriften)

Wooden facade cladding can display a number of natural characteristics which are inherent to the material (wood) and dependent on the installation. Have you noted some minor imperfections in the paint as a result of these natural properties? Then this will not be covered by our warranty.

It's important to regularly inspect the facade cladding and follow these maintenance instructions in order to comply with the warranty conditions.

### Inspection

You're obliged to regularly inspect the facade cladding for any possible scratches and/or damage. You will need to immediately clean any scratches and/or damage and treat them with two layers of FalcOnWood paint. Always conduct an annual inspection of the paintwork, allowing you to check whether any (partial) painting is needed. Extra attention and/or earlier painting may also be required for parts in full sun, exposed locations, wooded areas, salty air, coastal areas, lying parts, as a result of non-periodic cleaning and poor maintenance.

### Cleaning

The facade cladding must be cleaned on an annual basis. This can be done with water and a soft brush. Cleaning with a cleaning agent may be necessary if there's any algae or sea salt contamination. Use a product prescribed by us for this purpose. Not every cleaning agent is going to be suitable for this!

### Maintenance interval painting

A (complete) repaint (major maintenance) is going to be required after an average period of approximately 10 years if the facade cladding has been installed and maintained in line with the correct instructions. This is a rough estimate, as it will depend on the construction, weather conditions and location of the building. Painting will always be subject to external (weather) factors. Any parts which are touched up will therefore almost always show color and gloss differences compared to the existing paintwork. Good care and timely maintenance will ensure a long-lasting result.

This brochure will provide you with an abbreviated version of our maintenance instructions. You can find our complete maintenance instructions on: [www.falconwoodgevel.nl/onderhoudsvoorschriften](http://www.falconwoodgevel.nl/onderhoudsvoorschriften)



## 08 Warranty



### Warranty

Take a look at our complete warranty conditions on: [www.falconwoodgevel.nl/garantievoorwaarden](http://www.falconwoodgevel.nl/garantievoorwaarden)





# 09 Realized projects





# Keep in touch.

FalcOnWood Gevelbekleding B.V.  
Groot Overeem 1-A  
3927 GH Renswoude

☎ +31 318 798 129

✉ [info@falconwoodgevel.nl](mailto:info@falconwoodgevel.nl)

🌐 [www.falconwoodgevel.nl](http://www.falconwoodgevel.nl)

